

REVISION	DESCRIPTION	DATE

ITEM NO.	PART NUMBER	DESCRIPTION	QTY.
1	5909K59	STEEL WASHER FOR NEEDLE-ROLLER THRUST BEARING	2
2	90592A034	HEX HEAD NUT, M16 X 2.00	2
3	93325A345	THREADED ROD, M16 X 2.00, ~10.5" LONG	1
4	5909K33	THRUST NEEDLE-ROLLER BEARING WITH STEEL CAGE	1
5	7767T371	STEEL TUBING, 1" OD, .120 WALL, 2.5" LONG	1
6	--	.25" THICK CUSTOM WASHER 17MM ID, 2" OD	1

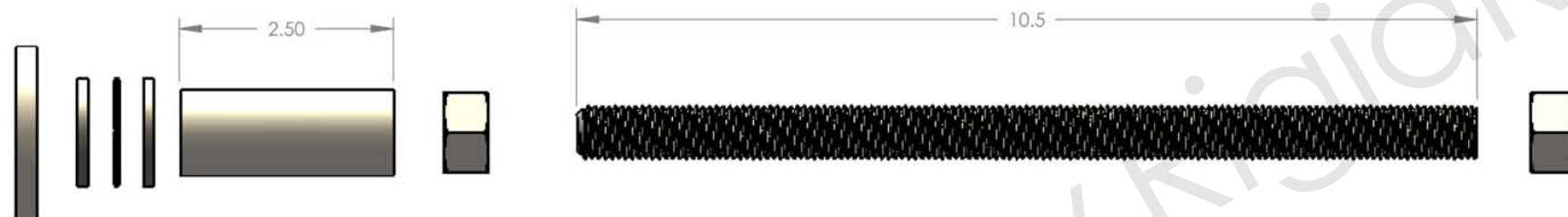
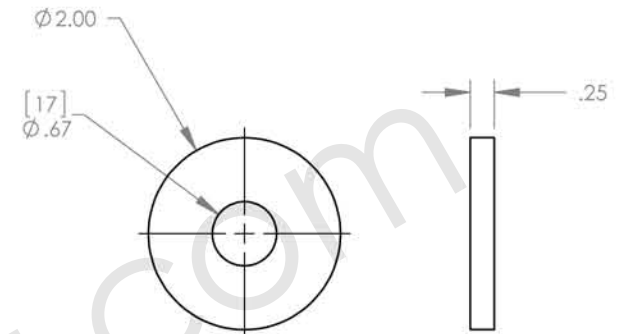
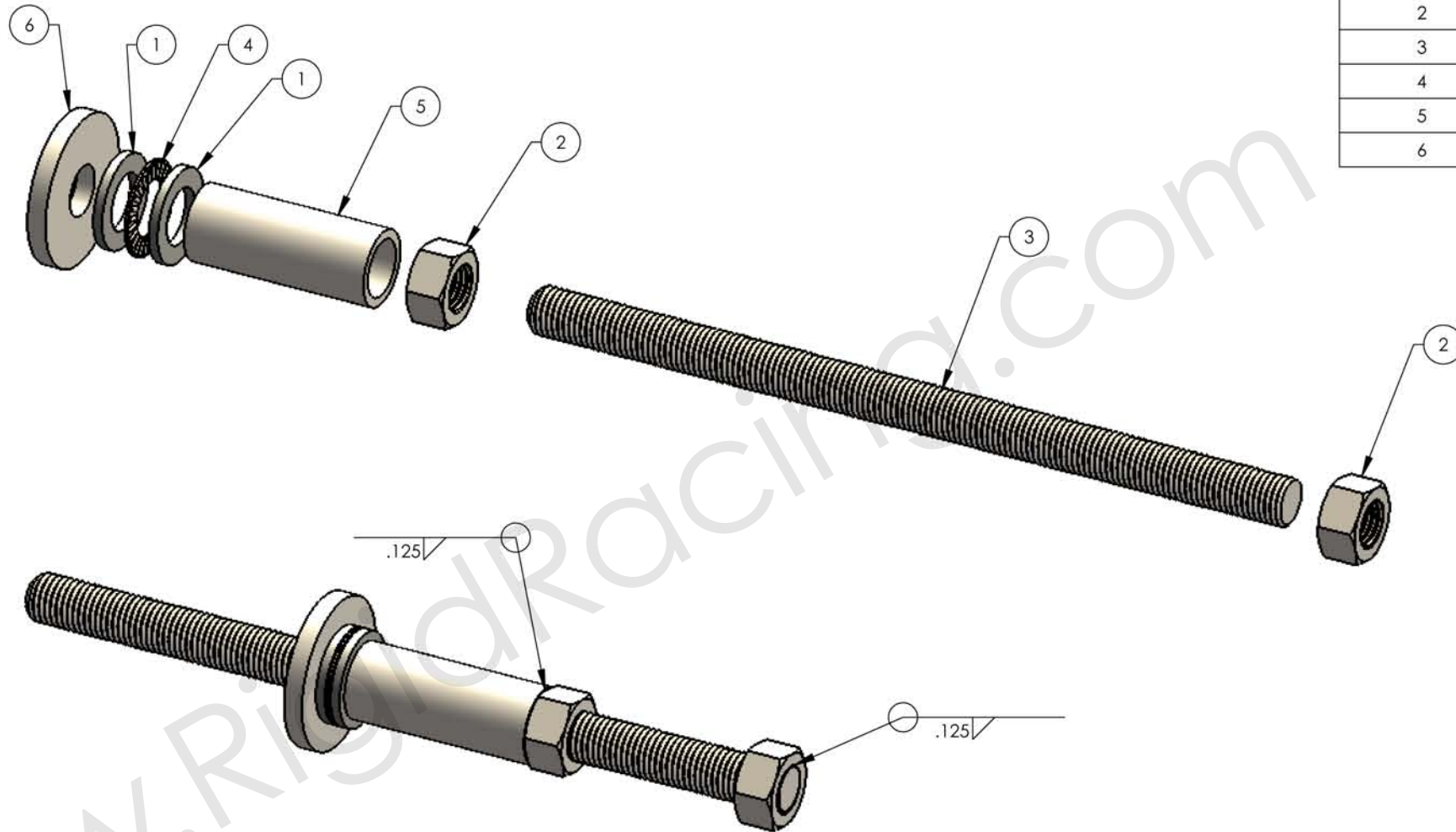

Rigid Racing

www.RigidRacing.com
Jeremiah@rigidracing.com

PROPRIETARY AND CONFIDENTIAL
THE INFORMATION CONTAINED IN THIS DRAWING IS THE SOLE PROPERTY OF JEREMIAH JORDAN. ANY REPRODUCTION IN PART OR AS A WHOLE WITHOUT THE WRITTEN PERMISSION OF JEREMIAH JORDAN IS STRICTLY PROHIBITED.

BREAK ALL EDGES AND SHARP CORNERS	
DIMENSIONS ARE IN INCHES	
TOLERANCES (UNLESS NOTED OTHERWISE)	
FABRICATION	MACHINE
X ± .063	.XX ± .03
.XX ± .063	.XXX ± .005
.XXX ± .063	.XXXX ± .0005
ANGULAR ± 1°	ANGULAR ± 1/2°
DO NOT SCALE DRAWING	
THIRD ANGLE PROJECTION	

MATERIAL:	FINISH:
L1 CRANK PULLEY INSTALLER	
WEIGHT: 1.39 LBS	DATE: 6/17/2013
SCALE: 1:2	REV: A
PART NO: --	SHEET: 1 OF 1
ORIGINATOR: JEREMIAH JORDAN	