

Rigid Racing

RRCL030007 Assembly Instructions. Master Cylinder Adapter Nissan 350Z

Revision 2/2/2017

Parts included with kit:

1. Aluminum adapter bracket (1 ea.)
2. Forged steel pedal fork (1 ea.)
3. Low profile socket head, M8x1.25, 30mm long (2 ea.)
4. Hex head cap screw, M8x1.25, 40mm long (2 ea.)
5. Washer (2 ea.)
6. Nut, nylon locking, M8x1.25 (2 ea.)
7. Low profile socket head, M8x1.25, 25mm long (1 ea.)**

1. Install two 30mm long socket head screws in back side of plate. See Figure 1. Torque hand tight or 10 ft-lbs. ***If using a Tilton 76 series low profile master cylinder install the provided 25mm long low profile socket in the top position for additional clearance. If using a Wilwood cylinder you will not use item #7.*

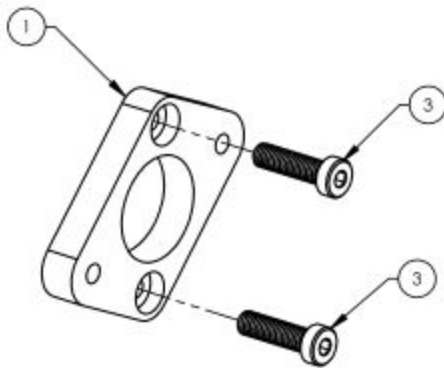

Figure 1

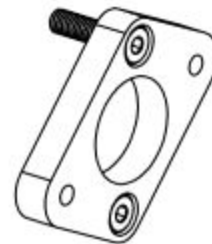

Figure 2

2. Install two hex head cap screws from front side of plate. Use a flat washer under each. See figure 3. Torque 10 ft-lbs or hand tight.

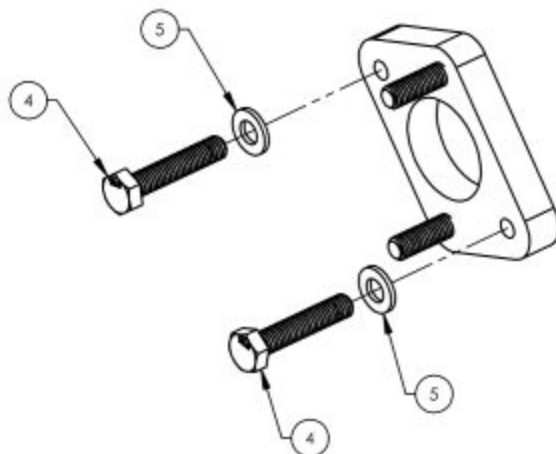

Figure 3



Figure 4

3. For most installations the master cylinder dust boot must be removed as it will not fit through the firewall hole. Install master cylinder on assembled bracket. Install the two nylock nuts per figure 5, torque 10 ft-lbs or hand tight. Install the fork on the master cylinder shaft, initially set to the same length from the base of plate as the OEM cylinder (should be adjusted after bleeding to get proper pedal engagement). Figure 6 shows the complete assembly.

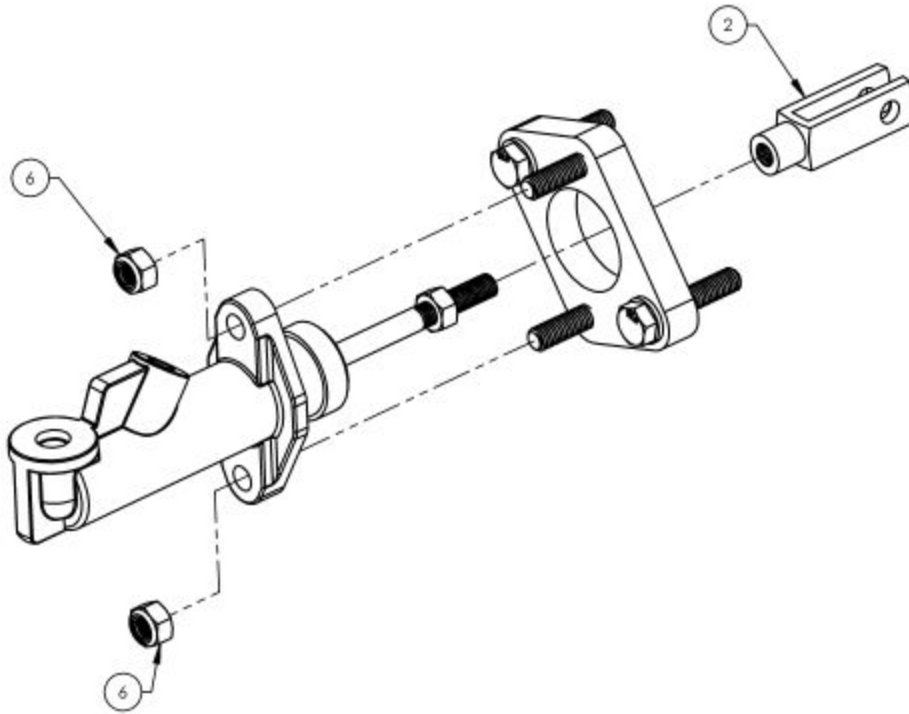

Figure 5

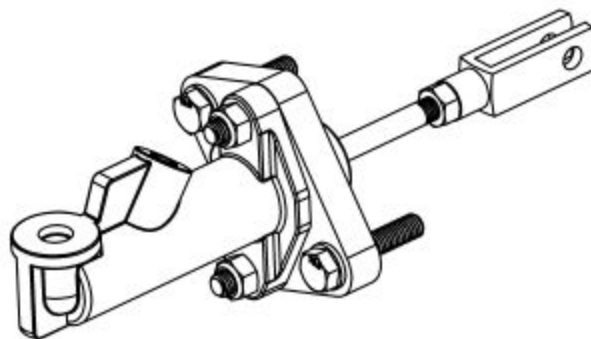

Figure 6: Complete Assembly

4. Install in vehicle using the OEM fork pin and pedal hardware just like the OEM cylinder. Torque per OEM manual. Professional installation is recommended. The master cylinder shaft will need to be adjusted to get proper pedal engagement. Custom lines will be required to connect to the slave cylinder.